

ELEVATION

Approved
 Planning Permit No. 553/324/2003
 SUBJECT TO THE CONDITIONS IN THIS OFFICE LETTER
 No. 11/37/19/03/20-9-2003
 FOR MEMBER SECRETARY
 CHENNAI METROPOLITAN DEVELOPMENT AUTHORITY
 CHENNAI - 600 008.

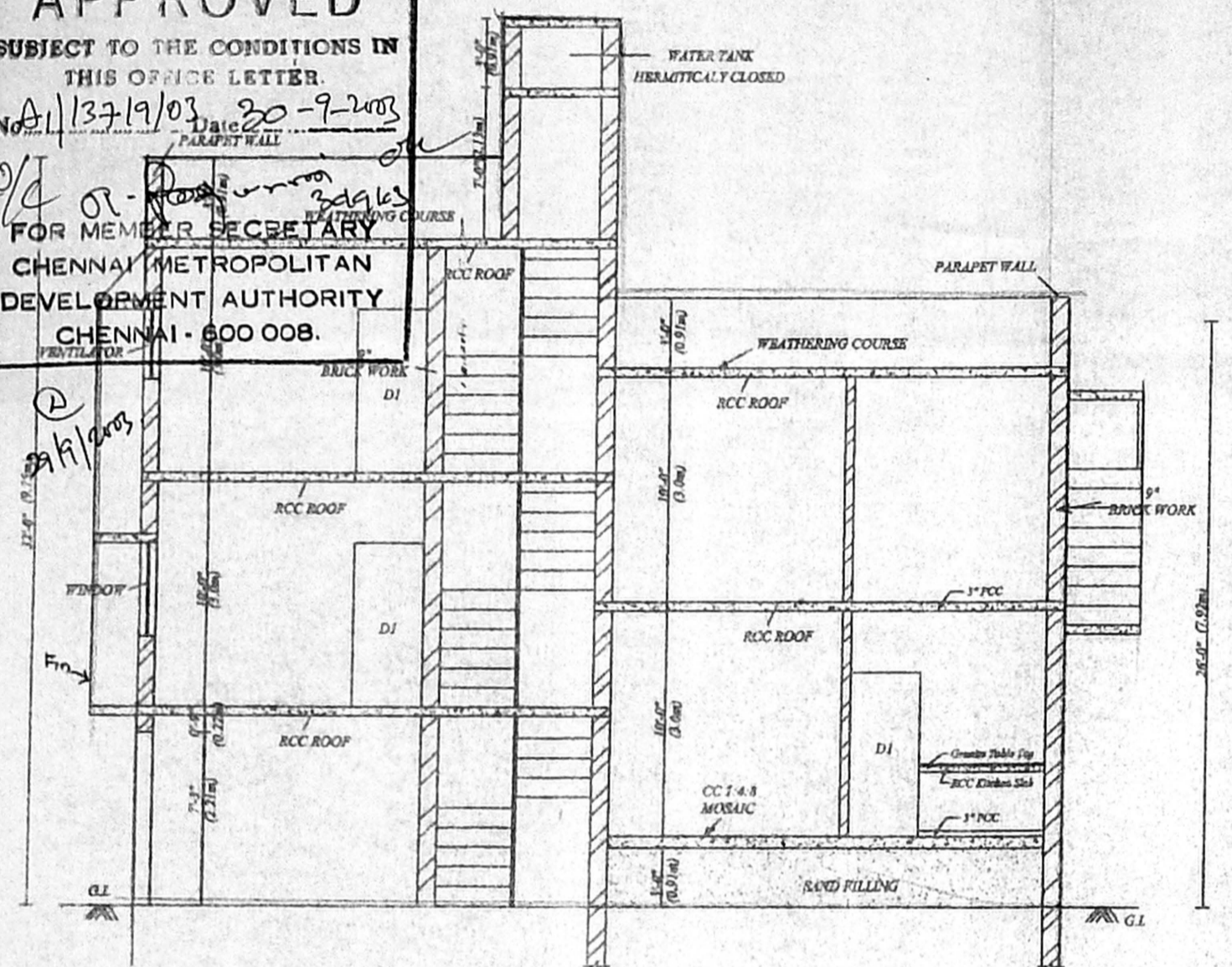

SECTION ON 'AA'

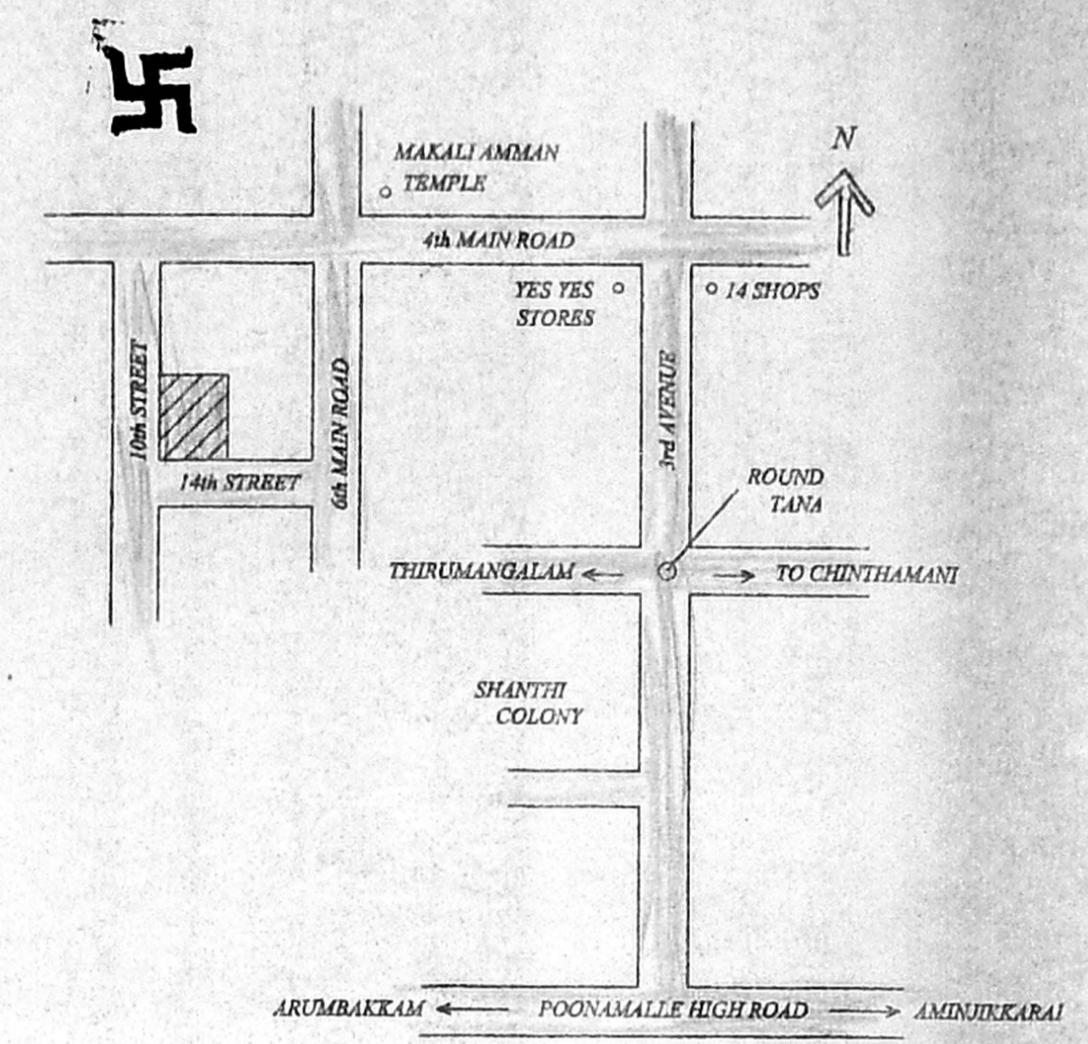

TOPO PLAN (N.T.S)

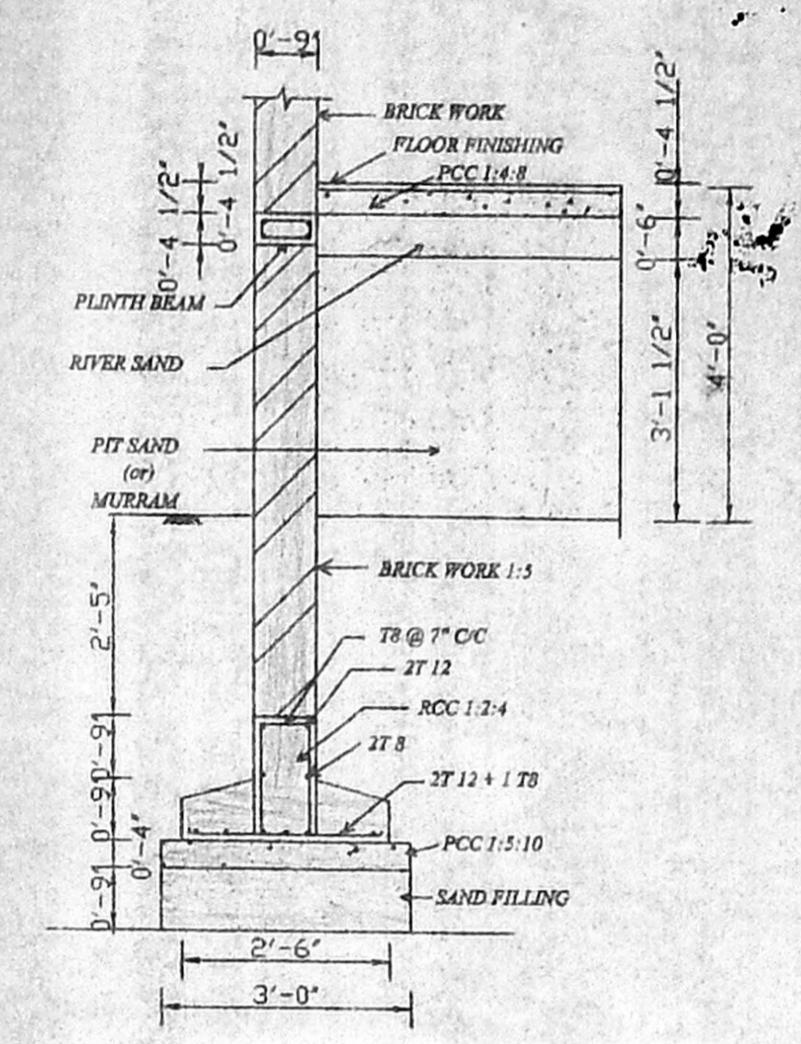

FOUNDATION DETAILS

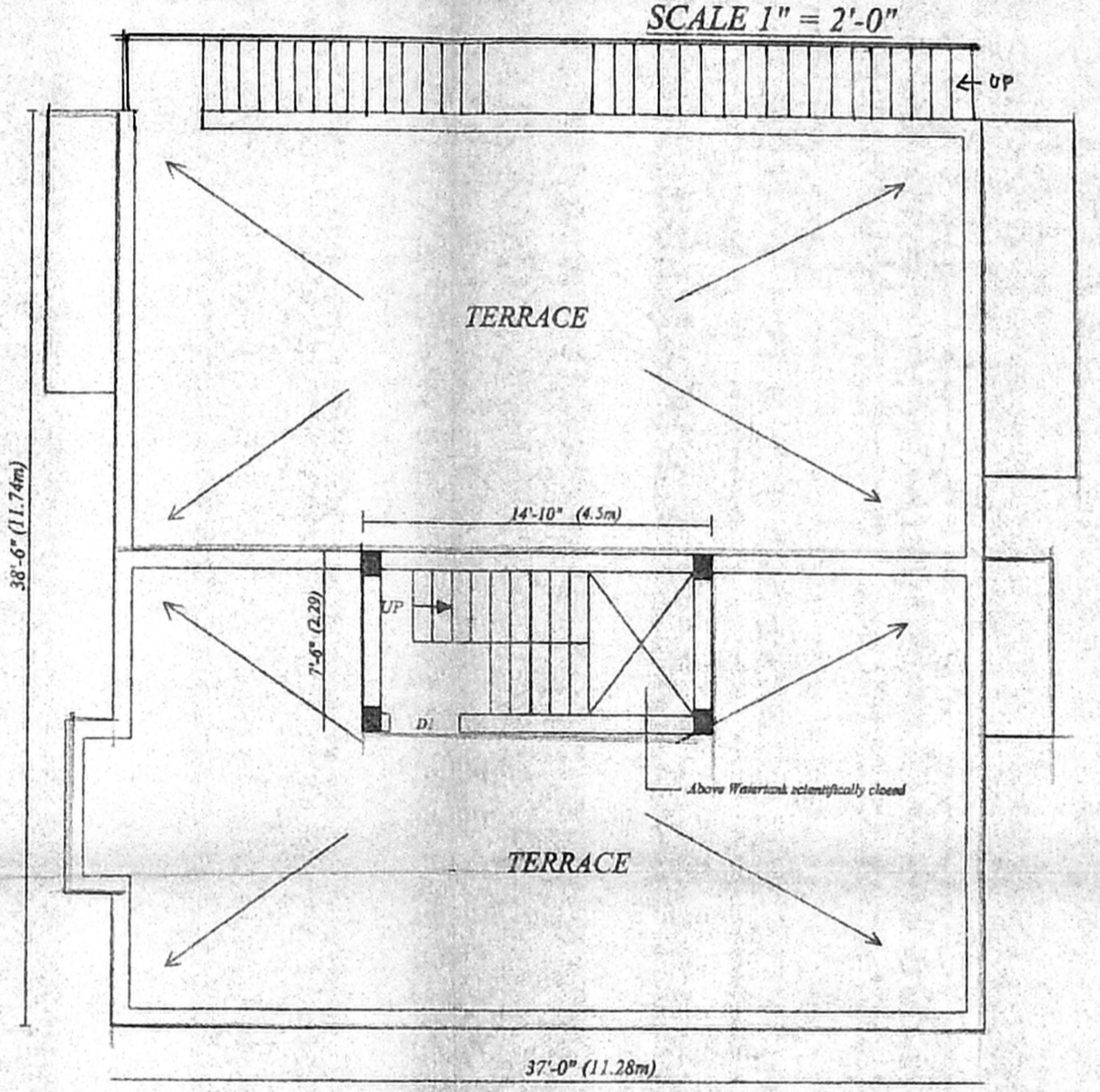

TERRACE FLOOR PLAN

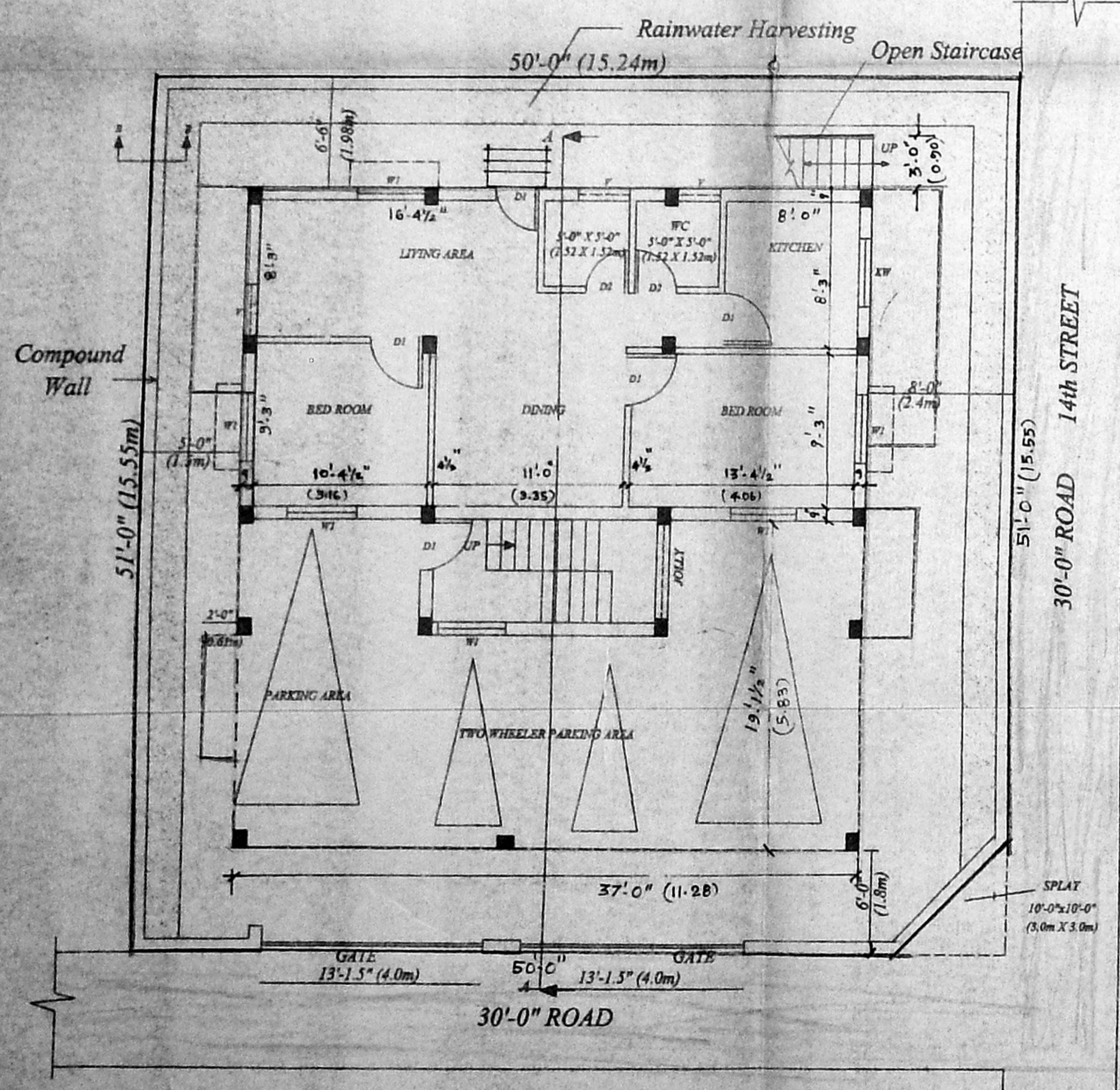

STILT, SITE & GROUND FLOOR PLAN

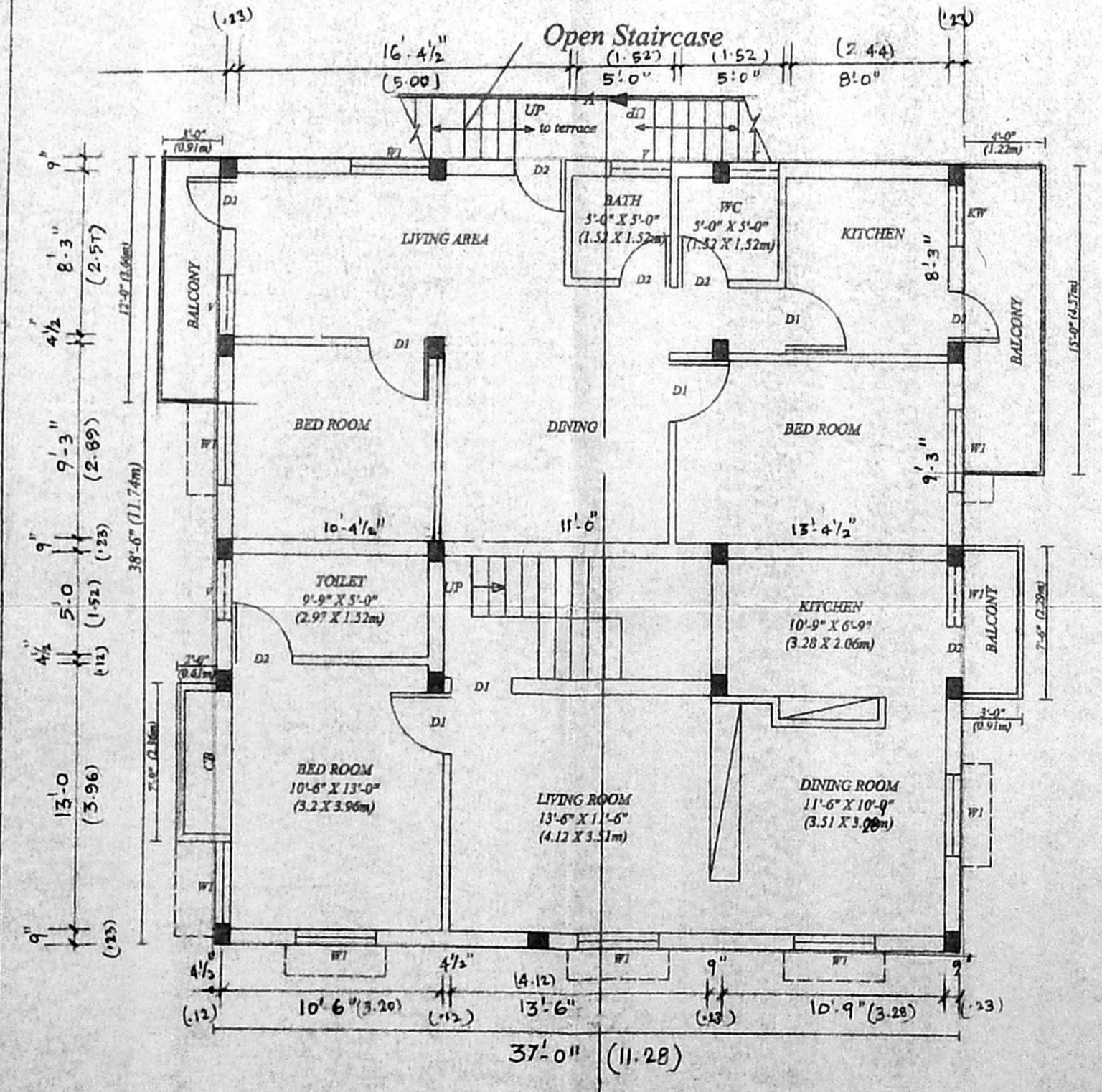

FIRST FLOOR PLAN

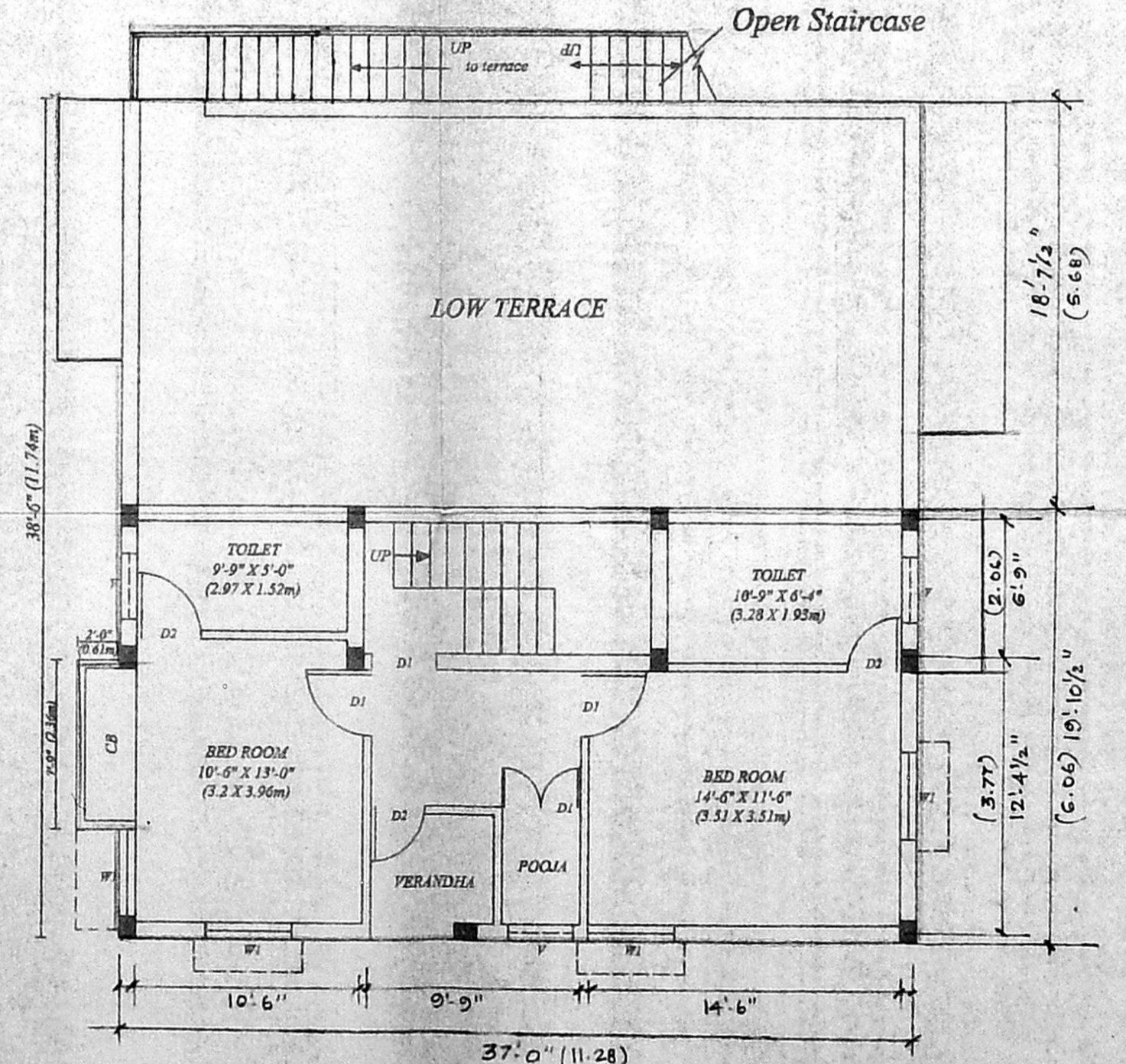

SECOND FLOOR PLAN (PART)

SCHEDULE OF JOINTS

MD	MAIN DOOR	3'-6" X 7'-0"	TEAK WOOD FLUSH DOOR
D	DOOR	3'-0" X 7'-0"	-DO-
DI	DOOR	2'-6" X 7'-0"	-DO-
W	WINDOW	5'-0" X 4'-0"	T.W. GLAZED WINDOW
KW	KIT. WINDOW	3'-6" X 3'-6"	Revised Plan -DORP
V	VENTILATOR	3'-0" X 2'-0"	T.W. GLAZED WINDOW

- SPECIFICATIONS
- FOUNDATION :- 1:2:4 Concrete footing in foundation
 - PLINTH BEAM :- Plinth beam are provided at lintel level
 - SUPER STRUCTURE :- Brick work in CM 1:5
 - PLASTERING :- Wall plastering in CM 1:5 & ceiling plastering in CM 1:3, 10 mm thick.
 - LINTEL :- RCC 1:2:4 cut lintel provided doors, windows, and ventilator opening
 - ROOFING :- RCC roof slab 1:2:4, 5" thick
 - WEATHERING COURSE :- Weathering course over land roof slab with proper slab
 - JOINERY :- Teak wood doors & windows
 - WHITE WASHING :- One coat primer
 - COLOUR WASHING :- Two coat colour wash with enamel paint.

PLAN SHOWING THE PROPOSED RESIDENTIAL BUILDING AT PLOT NO.4142, DOOR NO.15, Vth BLOCK, 14th STREET, ANNA NAGAR, CHENNAI - 40. IN T.S.NO.74 PART OF MULLAM VILLAGE

AREA STATEMENTS

AREA	IN SFT	IN SQ.M
G.F	824	76.57
M.F	751	69.79
FF	1559	144.88
TOTAL	3134	291.24

CAR PARKING : 2 PARKING
 PLOT AREA : 2525 sqft 234.66
 COVERAGE : 62% FSI : 1.2

COLOUR INDEX

BOUNDARY	
PROPOSED	
ROAD	

SCALE	1" = 8'-0"
DRG. NO.	
DATE	
CHECKED	
DRAWN	DRAWN

SIGNATURE OF OWNER

LICENSED SURVEYOR
 K.V. Venkatarame
 Er. K. V. VENKATARAMAN, D.C.E.,
 Civil & Sanitary Engineering
 304 Licensed Surveyor, Corporation of Chennai
 No. 3, Neelakandan Street,
 Nungambakkam, Chennai - 600 034.